



Minimum tube length



Spring loaded shaft

MDR Brushless DC Motor standard type PM380LS

Roller diameter $\varnothing 38$

Roller diameter $\varnothing 38$ PM380LS

- Roller diameter / $\varnothing 38$
- Thickness / t1.2
- Voltage / 24V DC
- Tube material / STKM12
- Surface treatment / Trivalent chromate processing

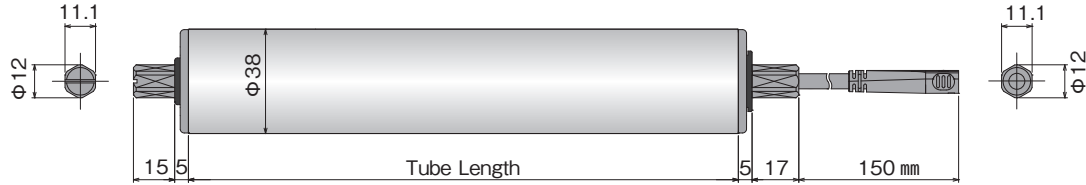

Tube Length : PM380LS

PM380LS-17



200mm

 ≥ 215 mm

Tube Length (mm)	200	300	400	500	600
Weight (kg)	1.0	1.1	1.2	1.3	1.4
Spring loaded shaft	×	○	○	○	○

PM380LS-60



200mm

 ≥ 200 mm

Tube Length (mm)	200	300	400	500	600
Weight (kg)	1.0	1.1	1.2	1.3	1.4
Spring loaded shaft	○	○	○	○	○

- Conveyor frame inside dimension and frame hole shape vary by the manufacturer.
- A gap of 2~5mm is required between the frame inside dimension and Power Moller. (Fix the product in the frame making the gap both ends even.)

Mounting Bracket : No.C-081

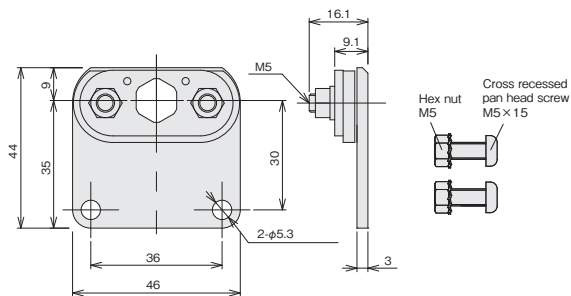

- Attach to the power cable side.
- Apply 3.0Nm for securing the Power Moller shaft, and 3.5Nm for securing the bracket.

Product Designation :

PM380LS - 60 - 200 - D - 024 - **VP**

Power Moller model Nominal Speed Tube Length Voltage Options

- Motor type : LS
- Nominal Speed : 17,60
- Tube Length : Specify in mm.
- Voltage : D-024 (24VDC)
- Options : Each of the following optional specification may be selected.

Options : PM380LS



Rubber Laggings - NR, UR, NB, CR

Natural rubber, Urethane, NBR, Neoprene



DR Drip Proof

200mm

 ≥ 200 mm ≥ 215 mm for nominal speed 17

WA Water Proof

 ≥ 200 mm ≥ 220 mm ≥ 215 mm for nominal speed 17 ≥ 235 mm for nominal speed 17

VG Poly V-Belt Pulley

200mm

 ≥ 200 mm ≥ 215 mm for nominal speed 17

VP V-Belt Pulley

200mm

 ≥ 200 mm ≥ 215 mm for nominal speed 17

- * Standard bracket for dropproof or waterproof is No.C-081-D (Stainless type).
- * For tube length or other specification availability, contact our sales support.

 [MDR Selection Tool] is available on our web page.

Operating characteristics with CBL-402F2 driver card

PM380LS-17

Speed (m/min)	Tangential Force (N)		Current (A)		Power Output (W)	Power Input (W)	RSW
	No-load	Rated	No-load	Starting			
17.4	70	199	0.4	2.6	26	38	9
14.5	72		0.3		23	37	8
11.6	74		0.3		21	35	7
8.7	77		0.2		16	29	6
7.2	78		0.2		13	25	5
5.8	79		0.1		10	22	4

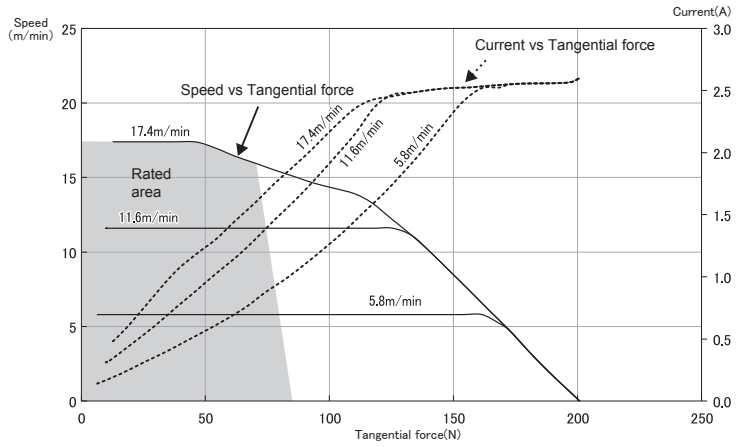

PM380LS-60

Speed (m/min)	Tangential Force (N)		Current (A)		Power Output (W)	Power Input (W)	RSW
	No-load	Rated	No-load	Starting			
60.0	23	64	0.4	2.6	26	38	9
50.0	23		0.3		23	37	8
40.0	24		0.3		21	35	7
30.0	25		0.2		16	29	6
25.0	25		0.2		13	25	5
20.0	26		0.1		10	22	4

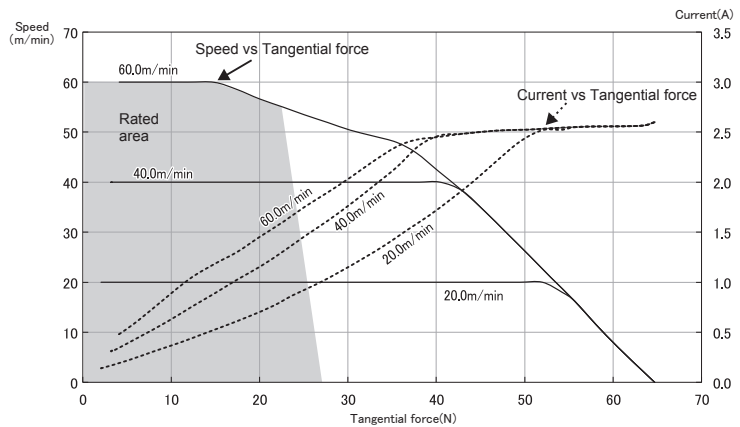

* The values in the characteristics list are when an ambient temperature is 25 degree C, and only for your reference and not the warranted values. The values represent the characteristics of a single standard motor roller (no linked operation) without including other specifications, and the values may change when including other specifications or with linked operation.