



Minimum tube length



Spring loaded shaft

MDR Brushless DC Motor standard type PM427LSRoller diameter $\varnothing 42.7$ **Roller diameter $\varnothing 42.7$
PM427LS**

- Roller diameter / $\varnothing 42.7$
- Thickness / t1.5
- Voltage / 24V DC
- Tube material / STKM12
- Surface treatment / Trivalent chromate processing

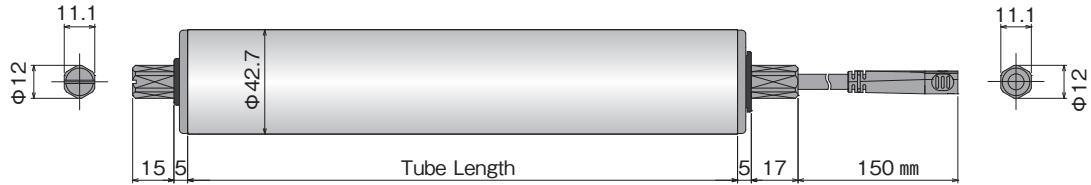
**Tube Length : PM427LS**

PM427LS-17



200mm

 ≥ 215 mm

Tube Length (mm)	200	300	400	500	600	700	800
Weight (kg)	1.3	1.4	1.5	1.6	1.7	1.8	1.9
Spring loaded shaft	X	O	O	O	O	O	O

PM427LS-60



200mm

 ≥ 200 mm

Tube Length (mm)	200	300	400	500	600	700	800
Weight (kg)	1.3	1.4	1.5	1.6	1.7	1.8	1.9
Spring loaded shaft	O	O	O	O	O	O	O

- Conveyor frame inside dimension and frame hole shape vary by the manufacturer.
- A gap of 2~5mm is required between the frame inside dimension and Power Moller. (Fix the product in the frame making the gap both ends even.)

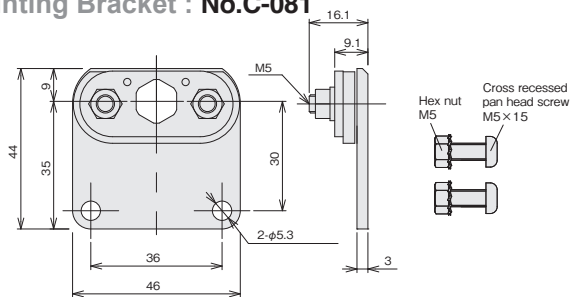
Mounting Bracket : No.C-081

- Attach to the power cable side.
- Apply 3.0Nm for securing the Power Moller shaft, and 3.5Nm for securing the bracket.

Product Designation :PM427LS - 60 - 200 - D - 024 - **VP**

Power Moller model Nominal Speed Tube Length Voltage Options

- Motor type** : LS
- Nominal Speed** : 17,60
- Tube Length** : Specify in mm.
- Voltage** : D-024 (24VDC)
- Options** : Each of the following optional specification may be selected.

Options : PM427LS**Rubber Laggings - NR, UR, NB, CR**

Natural rubber, Urethane, NBR, Neoprene

**DR Drip Proof**

200mm

 ≥ 200 mm ≥ 215 mm for nominal speed 17**WA Water Proof** ≥ 200 mm ≥ 220 mm ≥ 215 mm for nominal speed 17 ≥ 235 mm for nominal speed 17**VP V-Belt Pulley**

200mm

 ≥ 200 mm ≥ 215 mm for nominal speed 17

* Standard bracket for dropproof or waterproof is No.C-081-D (Stainless type).

* For tube length or other specification availability, contact our sales support.

 [MDR Selection Tool] is available on our web page.

Operating characteristics with CBL-402F2 driver card

PM427LS-17

Speed (m/min)	Tangential Force (N)		Current (A)		Power Output (W)	Power Input (W)	RSW
	No-load	Rated	No-load	Starting			
19.5	63	177	0.4	2.6	26	38	9
16.3	64		0.3		23	37	8
13.0	66		0.3		21	35	7
9.8	69		0.2		16	29	6
8.1	70		0.2		13	25	5
6.5	71		0.1		10	22	4

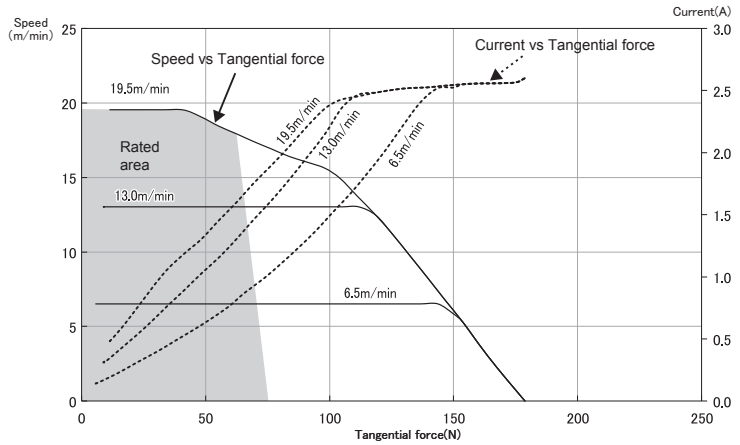

PM427LS-60

Speed (m/min)	Tangential Force (N)		Current (A)		Power Output (W)	Power Input (W)	RSW
	No-load	Rated	No-load	Starting			
67.4	20	57	0.4	2.6	26	38	9
56.2	21		0.3		23	37	8
45.0	21		0.3		21	35	7
33.7	22		0.2		16	29	6
28.1	22		0.2		13	25	5
22.5	23		0.1		10	22	4

