



Minimum tube length



Spring loaded shaft

MDR Brushless DC Motor standard type PM486FE

Roller diameter $\phi 48.6$

Roller diameter $\phi 48.6$ PM486FE

- Roller diameter / $\phi 48.6$
- Thickness / t1.4
- Voltage / 24V DC
- Tube material / STKM12
- Surface treatment / Trivalent chromate processing

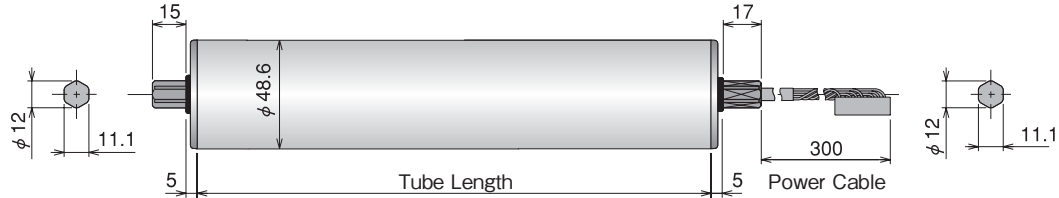

Tube Length : PM486FE

	290mm	290mm \leq						
Tube Length (mm)	300	400	500	600	700	800	900	1000
Weight (kg)	2.4	2.5	2.7	2.8	3.0	3.1	3.3	3.4
Spring loaded shaft	<input type="checkbox"/>	<input type="checkbox"/>	<input type="checkbox"/>	<input type="checkbox"/>	<input type="checkbox"/>	<input type="checkbox"/>	<input type="checkbox"/>	<input type="checkbox"/>

- Conveyor frame inside dimension and frame hole shape vary by the manufacturer.
- A gap of 2-5mm is required between the frame inside dimension and Power Moller.

Product Designation :

PM486FE - 17 - 400 - D - 024 - BR

Power Moller model Nominal Speed Tube Length Voltage Options

Motor type : FE

Nominal Speed : 17,60,210

Tube Length : Specify in mm.

Voltage : D-024 (24VDC)

Options : Each of the following optional specification may be selected.

Mounting Bracket : No.MBB-081

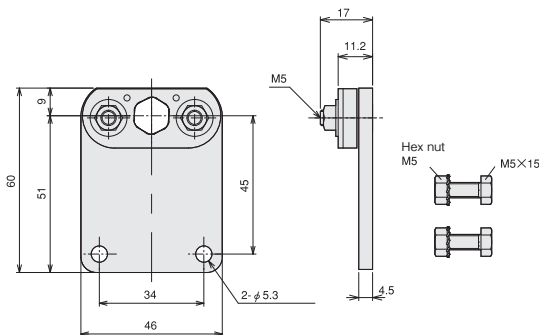

*Attach to the power cable side.

- Apply 6-10Nm torque for securing the Power Moller mounting shaft, and 3.5Nm for securing the bracket.

Options : PM486FE

	Rubber Laggings - NR, UR, NB, CR Natural rubber, Urethane, NBR, Neoprene	P.66
	BR Built-In Brake - BR^{*1} 360mm 360mm \leq	P.67
	VG Poly V-Belt Pulley 290mm 290mm \leq	P.70
	VP V-Belt Pulley 300mm 300mm \leq	P.71
	P2 Double Grooved Tube^{**2} 340mm 340mm \leq	P.72

JD

Both-end D-shaped shaft

*¹ When holding type built-in brake is required, specify along with a driver card compatible with such brake specification.

[Electric brake (no holding function)] is included in the standard specification.

*² Up to 800mm can be produced.

- For other specification, refer to P.73.

 [MDR Selection Tool] is available on our web page.

Operating characteristics with CB-016N6 driver card

PM486FE-17

Speed (m/min)		Tangential Force (N)		Input Current (A)		Power Input (W)	Power Output (W)	Internal Rotary Switch No.		External input voltage (V)
No-load	Rated	Rated	Starting	No-load	Starting			SW1#5	SW5	
16.9	14.6	119		0.8		45	67	9	9.6~9.9	344
15.5	14.6	119		0.7		45	67	8	9.1~9.4	
14.8	14.6	119		0.7		45	67	7	8.6~8.9	
14.1	14.1	120		0.6		43	67	6	8.1~8.4	
13.4	13.4	120		0.6		41	65	5	7.6~7.9	
12.7	12.7	121		0.6		39	64	4	7.1~7.4	
11.2	11.2	123		0.5		35	60	3	6.6~6.9	
10.5	10.5	123		0.5		32	56	2	6.1~6.4	
9.8	9.8	124		0.5		30	53	1	5.6~5.9	
9.1	9.1	125		0.5	4.0	28	52	0	5.1~5.4	
8.4	8.4	125		0.4		26	50	9	4.6~4.9	
7.7	7.7	126		0.4		24	48	8	4.1~4.4	
7.0	7.0	127		0.4		22	44	7	3.6~3.9	
6.3	6.3	128		0.4		20	41	6	3.1~3.4	
5.6	5.6	129		0.3		17	38	5	2.6~2.9	
4.9	4.9	129		0.3		15	37	4	2.1~2.4	
4.2	4.2	130		0.3		13	34	3	1.6~1.9	
3.5	3.5	131		0.2		11	31	2	1.1~1.4	
2.8	2.8	131		0.2		9	27	1	0.6~0.9	
2.1	2.1	132		0.2		7	25	0	0.1~0.4	

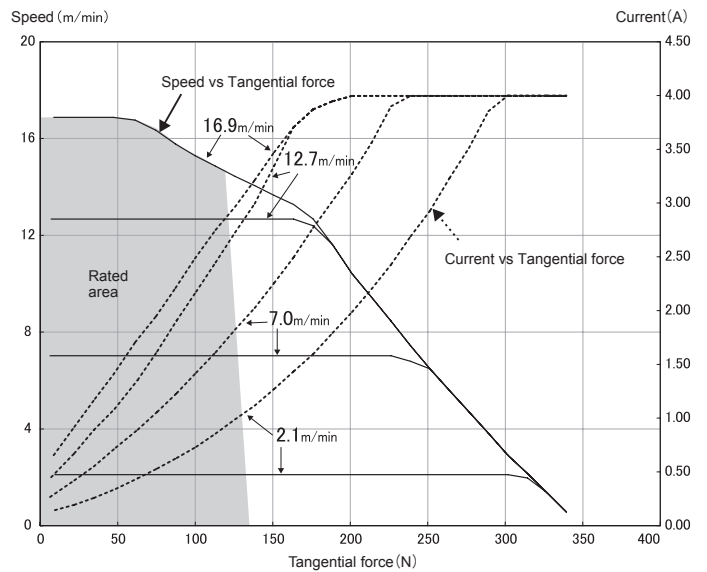

PM486FE-60

Speed (m/min)		Tangential Force (N)		Input Current (A)		Power Input (W)	Power Output (W)	Internal Rotary Switch No.		External input voltage (V)
No-load	Rated	Rated	Starting	No-load	Starting			SW1#5	SW5	
60.0	52.0	38		0.8		45	67	9	9.6~9.9	110
55.0	52.0	38		0.7		45	67	8	9.1~9.4	
52.5	52.0	38		0.7		45	67	7	8.6~8.9	
50.0	50.0	38		0.6		43	67	6	8.1~8.4	
47.5	47.5	38		0.6		41	65	5	7.6~7.9	
45.0	45.0	39		0.6		39	64	4	7.1~7.4	
40.0	40.0	39		0.5		35	60	3	6.6~6.9	
37.5	37.5	39		0.5		32	56	2	6.1~6.4	
35.0	35.0	40		0.5	4.0	30	53	1	5.6~5.9	
32.5	32.5	40		0.5		28	52	0	5.1~5.4	
30.0	30.0	40		0.4		26	50	9	4.6~4.9	
27.5	27.5	40		0.4		24	48	8	4.1~4.4	
25.0	25.0	41		0.4		22	44	7	3.6~3.9	
22.5	22.5	41		0.4		20	41	6	3.1~3.4	
20.0	20.0	41		0.3		17	38	5	2.6~2.9	
17.5	17.5	41		0.3		15	37	4	2.1~2.4	
15.0	15.0	42		0.3		13	34	3	1.6~1.9	
12.5	12.5	42		0.2		11	31	2	1.1~1.4	
10.0	10.0	42		0.2		9	28	1	0.6~0.9	
7.5	7.5	42		0.2		7	25	0	0.1~0.4	

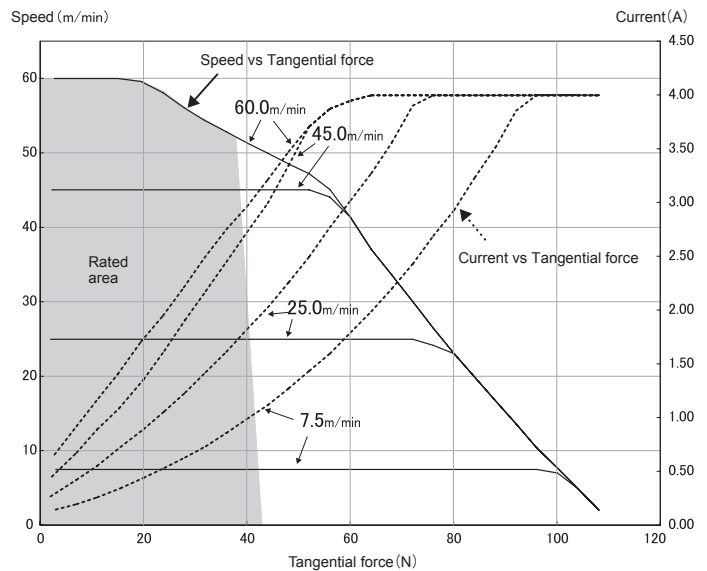

PM486FE-210

Speed (m/min)		Tangential Force (N)		Input Current (A)		Power Input (W)	Power Output (W)	Internal Rotary Switch No.		External input voltage (V)
No-load	Rated	Rated	Starting	No-load	Starting			SW1#5	SW5	
213.3	184.9	12		0.8		45	67	9	9.6~9.9	35
195.6	184.9	12		0.7		45	67	8	9.1~9.4	
186.7	184.9	12		0.7		45	67	7	8.6~8.9	
177.8	177.8	12		0.6		43	67	6	8.1~8.4	
168.9	168.9	12		0.6		41	65	5	7.6~7.9	
160.0	160.0	12		0.6		39	64	4	7.1~7.4	
142.2	142.2	13		0.5		35	60	3	6.6~6.9	
133.3	133.3	13		0.5		32	56	2	6.1~6.4	
124.4	124.4	13		0.5		30	53	1	5.6~5.9	
115.6	115.6	13		0.5	4.0	28	52	0	5.1~5.4	
106.7	106.7	13		0.4		26	50	9	4.6~4.9	
97.8	97.8	13		0.4		24	48	8	4.1~4.4	
88.9	88.9	13		0.4		22	44	7	3.6~3.9	
80.0	80.0	13		0.4		20	41	6	3.1~3.4	
71.1	71.1	13		0.3		17	38	5	2.6~2.9	
62.2	62.2	13		0.3		15	37	4	2.1~2.4	
53.3	53.3	13		0.3		13	34	3	1.6~1.9	
44.4	44.4	13		0.2		11	31	2	1.1~1.4	
35.6	35.6	13		0.2		9	28	1	0.6~0.9	
26.7	26.7	14		0.2		7	25	0	0.1~0.4	

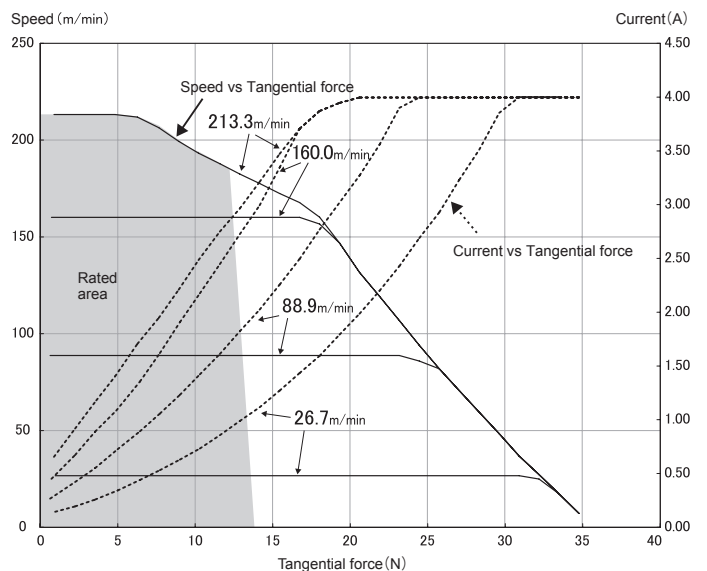

*The values in the characteristics list are only for your reference and not the warranted values. The values represent the characteristics of a single standard motor roller (no linked operation) without including other specifications, and the values may change when including other specifications or with linked operation.

 [MDR Selection Tool] is available on our web page.

Operating characteristics with HB-510N driver card

PM486FE-17

Speed (m/min)		Tangential Force (N)		Input Current (A)		Power Input (W)	Power Output (W)	Rotary SW No	External input voltage (V)
No-load	Rated	Rated	Starting	No-load	Starting				
16.9	15.2	103		0.8		42	62	9	9.3~9.7
15.5	15.2	103		0.7		42	62	8	8.3~8.7
14.1	14.1	104		0.6		39	60	7	7.3~7.7
12.7	12.7	106		0.6		35	56	6	6.3~6.7
11.2	11.2	107		0.5		31	51	5	5.3~5.7
9.8	9.8	109		0.5		27	47	4	4.3~4.7
8.4	8.4	110		0.4		23	43	3	3.3~3.7
7.0	7.0	111		0.4		19	38	2	2.3~2.7
5.6	5.6	113		0.3		16	34	1	1.3~1.7
4.2	4.2	115		0.3		12	29	0	0.3~0.7

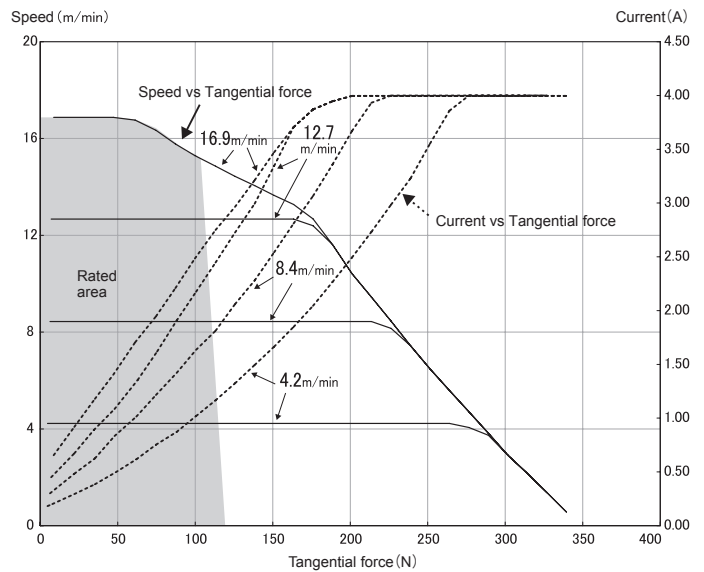

PM486FE-60

Speed (m/min)		Tangential Force (N)		Input Current (A)		Power Input (W)	Power Output (W)	Rotary SW No	External input voltage (V)
No-load	Rated	Rated	Starting	No-load	Starting				
60.0	54.0	33		0.8		42	62	9	9.3~9.7
55.0	54.0	33		0.7		42	62	8	8.3~8.7
50.0	50.0	33		0.6		39	60	7	7.3~7.7
45.0	45.0	34		0.6		35	56	6	6.3~6.7
40.0	40.0	34		0.5		31	51	5	5.3~5.7
35.0	35.0	35		0.5		27	47	4	4.3~4.7
30.0	30.0	35		0.4		23	43	3	3.3~3.7
25.0	25.0	36		0.4		19	38	2	2.3~2.7
20.0	20.0	36		0.3		16	34	1	1.3~1.7
15.0	15.0	37		0.3		12	29	0	0.3~0.7

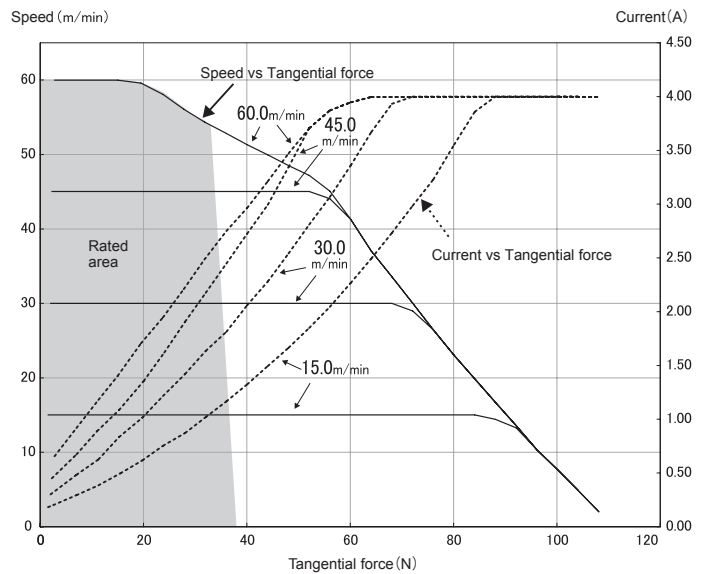

PM486FE-210

Speed (m/min)		Tangential Force (N)		Input Current (A)		Power Input (W)	Power Output (W)	Rotary SW No	External input voltage (V)
No-load	Rated	Rated	Starting	No-load	Starting				
213.3	192.0	11		0.8		42	62	9	9.3~9.7
195.6	192.0	11		0.7		42	62	8	8.3~8.7
177.8	177.8	11		0.6		39	60	7	7.3~7.7
160.0	160.0	11		0.6		35	56	6	6.3~6.7
142.2	142.2	11		0.5		31	51	5	5.3~5.7
124.4	124.4	11		0.5		27	47	4	4.3~4.7
106.7	106.7	11		0.4		23	43	3	3.3~3.7
88.9	88.9	11		0.4		19	38	2	2.3~2.7
71.1	71.1	12		0.3		16	34	1	1.3~1.7
53.3	53.3	12		0.3		12	29	0	0.3~0.7

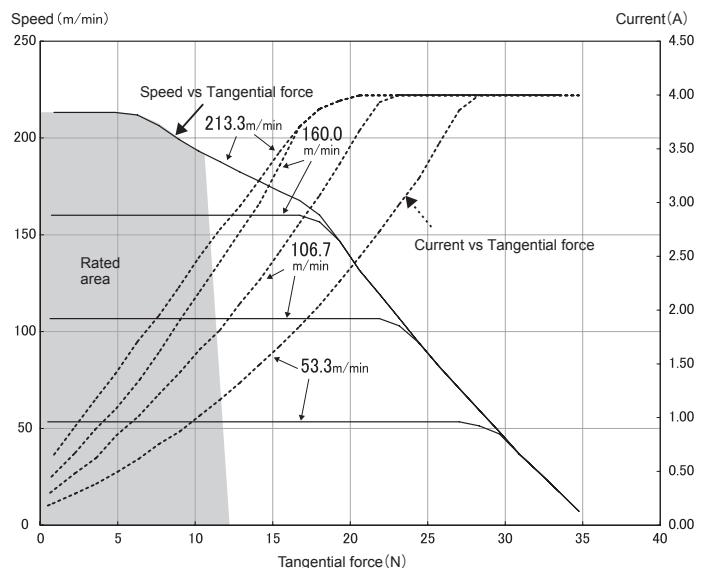

*The values in the characteristics list are only for your reference and not the warranted values. The values represent the characteristics of a single standard motor roller (no linked operation) without including other specifications, and the values may change when including other specifications or with linked operation.