



Minimum tube length



Spring loaded shaft

MDR Brushless DC Motor standard type PM500FE

Roller diameter $\varnothing 50$

Roller diameter $\varnothing 50$ PM500FE

- Roller diameter / $\varnothing 50$
- Thickness / t1.4
- Voltage / 24V DC
- Tube material / STKM12
- Surface treatment / Trivalent chromate processing

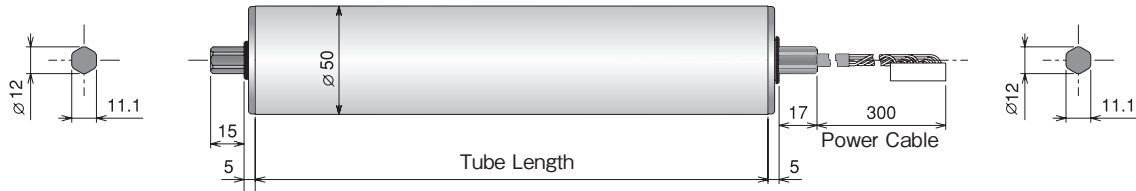

Tube Length : PM500FE

	290mm	290mm \leq						
Tube Length (mm)	300	400	500	600	700	800	900	1000
Weight (kg)	2.4	2.5	2.7	2.8	3.0	3.1	3.3	3.4
Spring loaded shaft	<input type="radio"/>	<input type="radio"/>	<input type="radio"/>	<input type="radio"/>	<input type="radio"/>	<input type="radio"/>	<input type="radio"/>	<input type="radio"/>

- Conveyor frame inside dimension and frame hole shape vary by the manufacturer.
- A gap of 2-5mm is required between the frame inside dimension and Power Moller.

Product Designation :

PM500FE - 17 - 400 - D - 024 - BR

Power Moller model Nominal Speed Tube Length Voltage Options

Motor type : FE

Nominal Speed : 17,60,210

Tube Length : Specify in mm.

Voltage : D-024 (24VDC)

Options : Each of the following optional specification may be selected.

Mounting Bracket : No.MBB-081

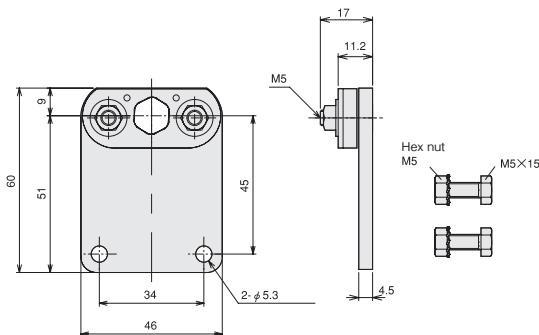

*Attach to the power cable side.

- Apply 6~10Nm torque for securing the Power Moller mounting shaft, and 3.5Nm for securing the bracket.

Options : PM500FE

**Rubber Laggings - NR, UR, NB, CR**

Natural rubber, Urethane, NBR, Neoprene

P.66

**BR Built-In Brake - BR^{*1}** 360mm 360mm \leq

P.67

**VG Poly V-Belt Pulley** 290mm 290mm \leq

P.70

**VP V-Belt Pulley** 290mm 290mm \leq

P.71

**P2 Double Grooved Tube^{**2}** 340mm 340mm \leq

P.72

JD**Both-end D-shaped shaft**

*1 When holding type built-in brake is required, specify along with a driver card compatible with such brake specification.

[Electric brake (no holding function)] is included in the standard specification.

*2 Up to 800mm can be produced.

- For other specification, refer to P.73.

 [MDR Selection Tool] is available on our web page.

Operating characteristics with CB-016N6 driver card

PM500FE-17

Speed (m/min)		Tangential Force (N)		Input Current (A)		Power Input (W)	Power Output (W)	Internal Rotary Switch No.		External input voltage (V)
No-load	Rated	Rated	Starting	No-load	Starting			SW1#5	SW5	
17.4	15.0	116		0.8		45	67	9	9.6~9.9	335
15.9	15.0	116		0.7		45	67	8	9.1~9.4	
15.2	15.0	116		0.7		45	67	7	8.6~8.9	
14.5	14.5	116		0.6		43	67	6	8.1~8.4	
13.7	13.7	117		0.6		41	65	5	7.6~7.9	
13.0	13.0	118		0.6		39	64	4	7.1~7.4	
11.6	11.6	119		0.5		35	60	3	6.6~6.9	
10.9	10.9	120		0.5		32	56	2	6.1~6.4	
10.1	10.1	120		0.5		30	53	1	5.6~5.9	
9.4	9.4	121		0.5		28	52	0	5.1~5.4	
8.7	8.7	122		0.4		26	50	9	4.6~4.9	
8.0	8.0	123		0.4		24	48	8	4.1~4.4	
7.2	7.2	123		0.4		22	44	7	3.6~3.9	
6.5	6.5	124		0.4		20	41	6	3.1~3.4	
5.8	5.8	125		0.3		17	38	5	2.6~2.9	
5.1	5.1	126		0.3		15	37	4	2.1~2.4	
4.3	4.3	127		0.3		13	34	3	1.6~1.9	
3.6	3.6	127		0.2		11	31	2	1.1~1.4	
2.9	2.9	128		0.2		9	28	1	0.6~0.9	
2.2	2.2	129		0.2		7	25	0	0.1~0.4	

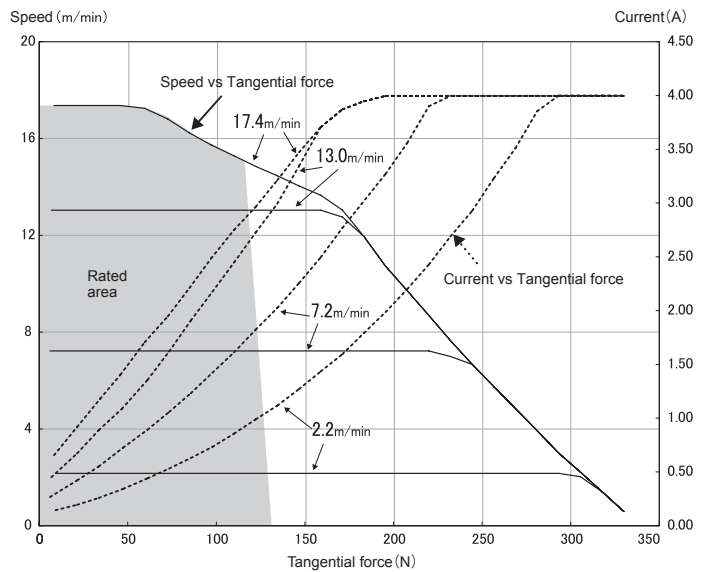

PM500FE-60

Speed (m/min)		Tangential Force (N)		Input Current (A)		Power Input (W)	Power Output (W)	Internal Rotary Switch No.		External input voltage (V)
No-load	Rated	Rated	Starting	No-load	Starting			SW1#5	SW5	
61.7	53.5	37		0.8		45	67	9	9.6~9.9	107
56.6	53.5	37		0.7		45	67	8	9.1~9.4	
54.0	53.5	37		0.7		45	67	7	8.6~8.9	
51.4	51.4	37		0.6		43	67	6	8.1~8.4	
48.9	48.9	37		0.6		41	65	5	7.6~7.9	
46.3	46.3	38		0.6		39	64	4	7.1~7.4	
41.2	41.2	38		0.5		35	60	3	6.6~6.9	
38.6	38.6	38		0.5		32	56	2	6.1~6.4	
36.0	36.0	38		0.5		30	53	1	5.6~5.9	
33.4	33.4	39		0.5		28	52	0	5.1~5.4	
30.9	30.9	39		0.4		26	50	9	4.6~4.9	
28.3	28.3	39		0.4		24	48	8	4.1~4.4	
25.7	25.7	39		0.4		22	44	7	3.6~3.9	
23.1	23.1	40		0.4		20	41	6	3.1~3.4	
20.6	20.6	40		0.3		17	38	5	2.6~2.9	
18.0	18.0	40		0.3		15	37	4	2.1~2.4	
15.4	15.4	40		0.3		13	34	3	1.6~1.9	
12.9	12.9	41		0.2		11	31	2	1.1~1.4	
10.3	10.3	41		0.2		9	28	1	0.6~0.9	
7.7	7.7	41		0.2		7	25	0	0.1~0.4	

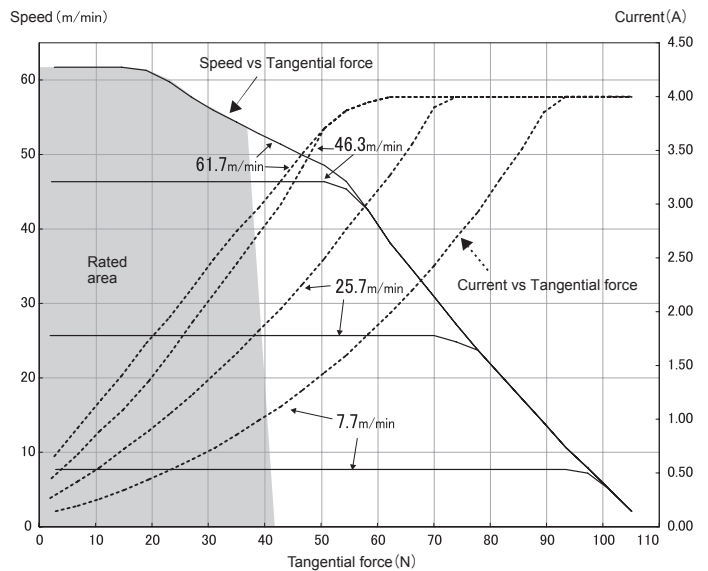

PM500FE-210

Speed (m/min)		Tangential Force (N)		Input Current (A)		Power Input (W)	Power Output (W)	Internal Rotary Switch No.		External input voltage (V)
No-load	Rated	Rated	Starting	No-load	Starting			SW1#5	SW5	
219.5	190.2	12		0.8		45	67	9	9.6~9.9	34
201.2	190.2	12		0.7		45	67	8	9.1~9.4	
192.0	190.2	12		0.7		45	67	7	8.6~8.9	
182.9	182.9	12		0.6		43	67	6	8.1~8.4	
173.8	173.8	12		0.6		41	65	5	7.6~7.9	
164.6	164.6	12		0.6		39	64	4	7.1~7.4	
146.3	146.3	12		0.5		35	60	3	6.6~6.9	
137.2	137.2	12		0.5		32	56	2	6.1~6.4	
128.0	128.0	12		0.5		30	53	1	5.6~5.9	
118.9	118.9	12		0.5		28	52	0	5.1~5.4	
109.7	109.7	12		0.4		26	50	9	4.6~4.9	
100.6	100.6	13		0.4		24	48	8	4.1~4.4	
91.5	91.5	13		0.4		22	44	7	3.6~3.9	
82.3	82.3	13		0.4		20	41	6	3.1~3.4	
73.2	73.2	13		0.3		17	38	5	2.6~2.9	
64.0	64.0	13		0.3		15	37	4	2.1~2.4	
54.9	54.9	13		0.3		13	34	3	1.6~1.9	
45.7	45.7	13		0.2		11	31	2	1.1~1.4	
36.6	36.6	13		0.2		9	28	1	0.6~0.9	
27.4	27.4	13		0.2		7	25	0	0.1~0.4	

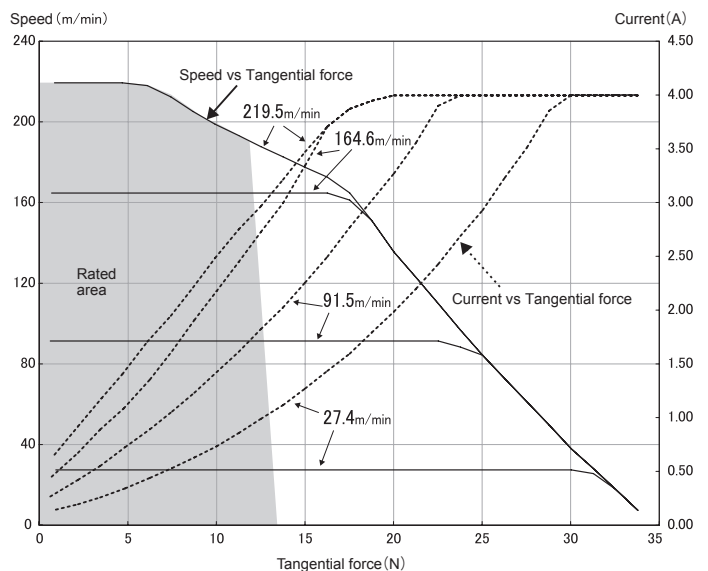

*The values in the characteristics list are only for your reference and not the warranted values. The values represent the characteristics of a single standard motor roller (no linked operation) without including other specifications, and the values may change when including other characteristics or with linked operation.

 [MDR Selection Tool] is available on our web page.

Operating characteristics with HB-510N driver card

PM500FE-17

Speed (m/min)		Tangential Force (N)		Input Current (A)		Power Input (W)	Power Output (W)	Rotary SW No	External input voltage (V)
No-load	Rated	Rated	Starting	No-load	Starting				
17.4	15.6	100		0.8		42	62	9	9.3~9.7
15.9	15.6	100		0.7		42	62	8	8.3~8.7
14.5	14.5	101		0.6		39	60	7	7.3~7.7
13.0	13.0	103		0.6		35	56	6	6.3~6.7
11.6	11.6	104		0.5		31	51	5	5.3~5.7
10.1	10.1	106		0.5		27	47	4	4.3~4.7
8.7	8.7	107		0.4		23	43	3	3.3~3.7
7.2	7.2	108		0.4		19	38	2	2.3~2.7
5.8	5.8	110		0.3		16	34	1	1.3~1.7
4.3	4.3	111		0.3		12	29	0	0.3~0.7

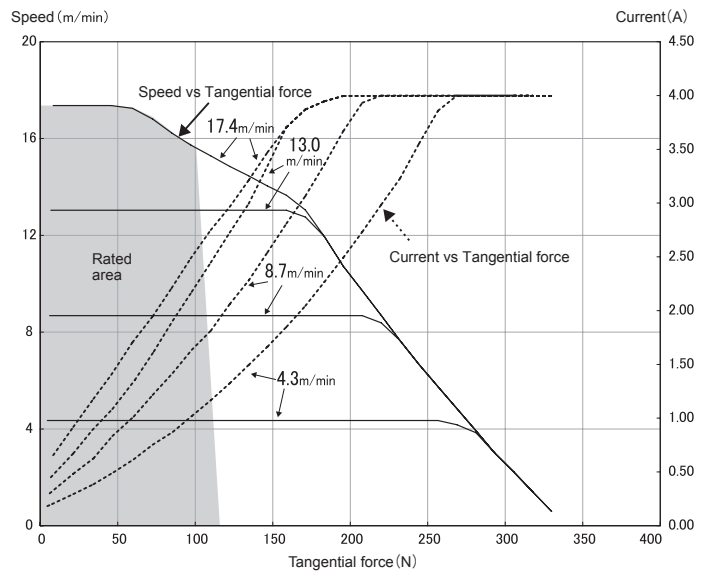

PM500FE-60

Speed (m/min)		Tangential Force (N)		Input Current (A)		Power Input (W)	Power Output (W)	Rotary SW No	External input voltage (V)
No-load	Rated	Rated	Starting	No-load	Starting				
61.7	55.6	32		0.8		42	62	9	9.3~9.7
56.6	55.6	32		0.7		42	62	8	8.3~8.7
51.4	51.4	32		0.6		39	60	7	7.3~7.7
46.3	46.3	33		0.6		35	56	6	6.3~6.7
41.2	41.2	33		0.5		31	51	5	5.3~5.7
36.0	36.0	34		0.5		27	47	4	4.3~4.7
30.9	30.9	34		0.4		23	43	3	3.3~3.7
25.7	25.7	35		0.4		19	38	2	2.3~2.7
20.6	20.6	35		0.3		16	34	1	1.3~1.7
15.4	15.4	36		0.3		12	29	0	0.3~0.7

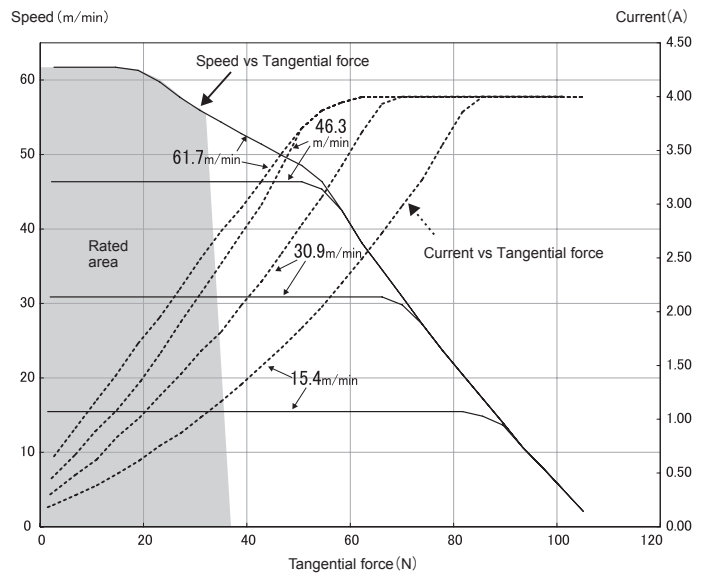

PM500FE-210

Speed (m/min)		Tangential Force (N)		Input Current (A)		Power Input (W)	Power Output (W)	Rotary SW No	External input voltage (V)
No-load	Rated	Rated	Starting	No-load	Starting				
219.5	197.5	10		0.8		42	62	9	9.3~9.7
201.2	197.5	10		0.7		42	62	8	8.3~8.7
182.9	182.9	10		0.6		39	60	7	7.3~7.7
164.6	164.6	10		0.6		35	56	6	6.3~6.7
146.3	146.3	11		0.5		31	51	5	5.3~5.7
128.0	128.0	11		0.5		27	47	4	4.3~4.7
109.7	109.7	11		0.4		23	43	3	3.3~3.7
91.5	91.5	11		0.4		19	38	2	2.3~2.7
73.2	73.2	11		0.3		16	34	1	1.3~1.7
54.9	54.9	11		0.3		12	29	0	0.3~0.7

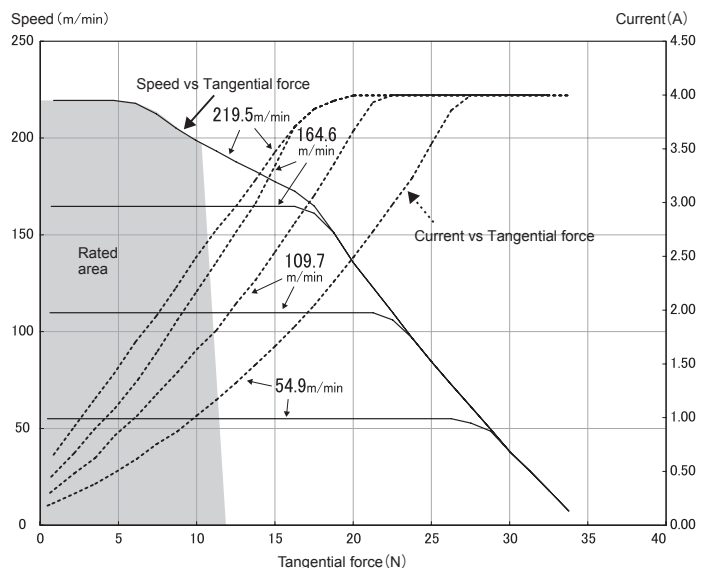

*The values in the characteristics list are only for your reference and not the warranted values. The values represent the characteristics of a single standard motor roller (no linked operation) without including other specifications, and the values may change when including other specifications or with linked operation.