



Minimum tube length



Spring loaded shaft

**MDR Brushless DC Motor standard type PM570FE****Roller diameter  $\varnothing 57$** **Roller diameter  $\varnothing 57$   
PM570FE**

- Roller diameter /  $\varnothing 57$
- Thickness / t1.5
- Voltage / 24V DC
- Tube material / STKM12
- Surface treatment / Trivalent chromate processing

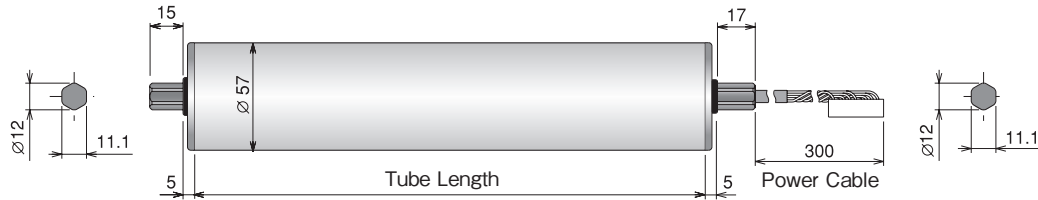
**Tube Length : PM570FE**

	300mm	300mm $\leq$						
Tube Length (mm)	300	400	500	600	700	800	900	1000
Weight (kg)	2.8	3.0	3.2	3.4	3.6	3.8	4.0	4.2
Spring loaded shaft	<input type="radio"/>	<input type="radio"/>	<input type="radio"/>	<input type="radio"/>	<input type="radio"/>	<input type="radio"/>	<input type="radio"/>	<input type="radio"/>

- Conveyor frame inside dimension and frame hole shape vary by the manufacturer.
- A gap of 2-5mm is required between the frame inside dimension and Power Moller.

**Product Designation :****PM570FE - 17 - 400 - D - 024 - BR**

Power Moller model    Nominal Speed    Tube Length    Voltage    Options

- Motor type : FE
- Nominal Speed : 17,60,210
- Tube Length : Specify in mm.
- Voltage : D-024 (24VDC)
- Options : Each of the following optional specification may be selected.

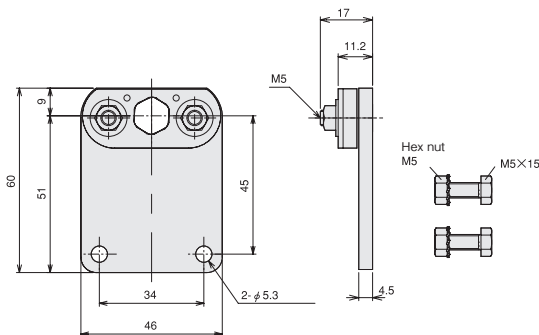
**Mounting Bracket : No.MBB-081**

\*Attach to the power cable side.

- Apply 6-10Nm torque for securing the Power Moller mounting shaft, and 3.5Nm for securing the bracket.

**Options : PM570FE**

	<b>Rubber Laggings - NR, UR, NB, CR</b> Natural rubber, Urethane, NBR, Neoprene	
	<b>Built-In Brake - BR<sup>*1</sup></b> 370mm     370mm $\leq$	
	<b>Poly V-Belt Pulley</b> 300mm     300mm $\leq$	
	<b>V-Belt Pulley</b> 300mm     300mm $\leq$	
	<b>Double Grooved Tube<sup>**2</sup></b> 360mm     360mm $\leq$	

**Both-end D-shaped shaft**\*<sup>1</sup> When holding type built-in brake is required, specify along with a driver card compatible with such brake specification.

[Electric brake (no holding function)] is included in the standard specification.

\*<sup>2</sup> Up to 800mm can be produced.

- For other specification, refer to P.73.

 [MDR Selection Tool] is available on our web page.

## Operating characteristics with CB-016N6 driver card

### PM570FE-17

Speed (m/min)		Tangential Force (N)		Input Current (A)		Power Input (W)	Power Output (W)	Internal Rotary Switch No.		External input voltage (V)
No-load	Rated	Rated	Starting	No-load	Starting			SW1#5	SW5	
19.8	17.2	101		0.8		45	67	9	9.6~9.9	293
18.1	17.2	101		0.7		45	67	8	9.1~9.4	
17.3	17.2	101		0.7		45	67	7	8.6~8.9	
16.5	16.5	102		0.6		43	67	6	8.1~8.4	
15.7	15.7	102		0.6		41	65	5	7.6~7.9	
14.8	14.8	103		0.6		39	64	4	7.1~7.4	
13.2	13.2	105		0.5		35	60	3	6.6~6.9	
12.4	12.4	105		0.5		32	56	2	6.1~6.4	
11.5	11.5	106		0.5		30	53	1	5.6~5.9	
10.7	10.7	106		0.5	4.0	28	52	0	5.1~5.4	
9.9	9.9	107		0.4		26	50	9	4.6~4.9	
9.1	9.1	108		0.4		24	48	8	4.1~4.4	
8.2	8.2	108		0.4		22	44	7	3.6~3.9	
7.4	7.4	109		0.4		20	41	6	3.1~3.4	
6.6	6.6	110		0.3		17	38	5	2.6~2.9	
5.8	5.8	110		0.3		15	37	4	2.1~2.4	
4.9	4.9	111		0.3		13	34	3	1.6~1.9	
4.1	4.1	112		0.2		11	31	2	1.1~1.4	
3.3	3.3	112		0.2		9	28	1	0.6~0.9	
2.5	2.5	113		0.2		7	25	0	0.1~0.4	

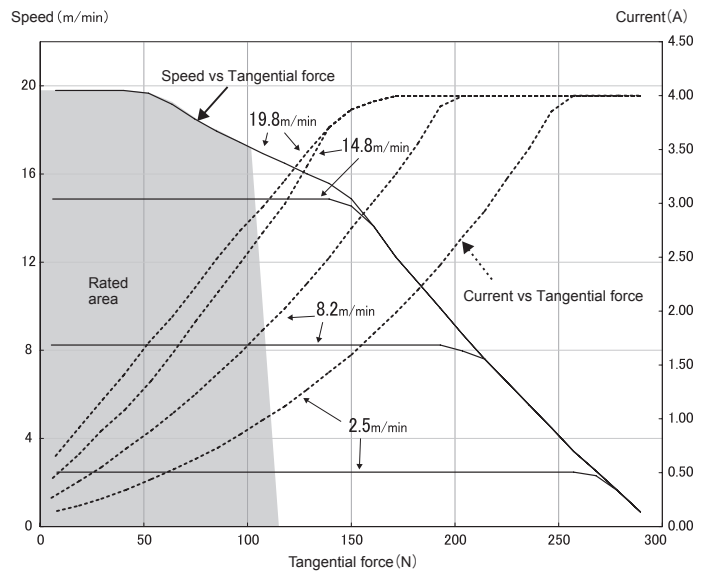

### PM570FE-60

Speed (m/min)		Tangential Force (N)		Input Current (A)		Power Input (W)	Power Output (W)	Internal Rotary Switch No.		External input voltage (V)
No-load	Rated	Rated	Starting	No-load	Starting			SW1#5	SW5	
70.4	61.0	32		0.8		45	67	9	9.6~9.9	94
64.5	61.0	32		0.7		45	67	8	9.1~9.4	
61.6	61.0	32		0.7		45	67	7	8.6~8.9	
58.6	58.6	33		0.6		43	67	6	8.1~8.4	
55.7	55.7	33		0.6		41	65	5	7.6~7.9	
52.8	52.8	33		0.6		39	64	4	7.1~7.4	
46.9	46.9	33		0.5		35	60	3	6.6~6.9	
44.0	44.0	34		0.5		32	56	2	6.1~6.4	
41.0	41.0	34		0.5	4.0	30	53	1	5.6~5.9	
38.1	38.1	34		0.5		28	52	0	5.1~5.4	
35.2	35.2	34		0.4		26	50	9	4.6~4.9	
32.3	32.3	34		0.4		24	48	8	4.1~4.4	
29.3	29.3	35		0.4		22	44	7	3.6~3.9	
26.4	26.4	35		0.4		20	41	6	3.1~3.4	
23.5	23.5	35		0.3		17	38	5	2.6~2.9	
20.5	20.5	35		0.3		15	37	4	2.1~2.4	
17.6	17.6	35		0.3		13	34	3	1.6~1.9	
14.7	14.7	36		0.2		11	31	2	1.1~1.4	
11.7	11.7	36		0.2		9	28	1	0.6~0.9	
8.8	8.8	36		0.2		7	25	0	0.1~0.4	

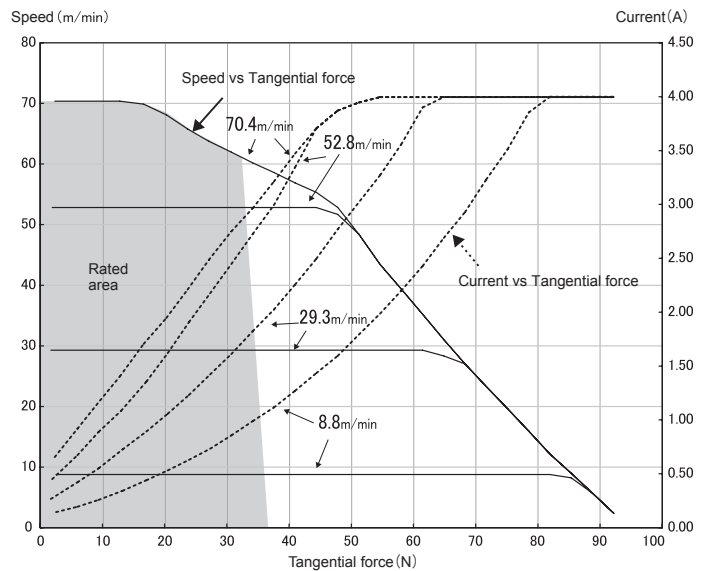

### PM570FE-210

Speed (m/min)		Tangential Force (N)		Input Current (A)		Power Input (W)	Power Output (W)	Internal Rotary Switch No.		External input voltage (V)
No-load	Rated	Rated	Starting	No-load	Starting			SW1#5	SW5	
250.2	216.8	10		0.8		45	67	9	9.6~9.9	30
229.4	216.8	10		0.7		45	67	8	9.1~9.4	
218.9	216.8	10		0.7		45	67	7	8.6~8.9	
208.5	208.5	10		0.6		43	67	6	8.1~8.4	
198.1	198.1	10		0.6		41	65	5	7.6~7.9	
187.7	187.7	11		0.6		39	64	4	7.1~7.4	
166.8	166.8	11		0.5		35	60	3	6.6~6.9	
156.4	156.4	11		0.5		32	56	2	6.1~6.4	
146.0	146.0	11		0.5		30	53	1	5.6~5.9	
135.5	135.5	11		0.5	4.0	28	52	0	5.1~5.4	
125.1	125.1	11		0.4		26	50	9	4.6~4.9	
114.7	114.7	11		0.4		24	48	8	4.1~4.4	
104.3	104.3	11		0.4		22	44	7	3.6~3.9	
93.8	93.8	11		0.4		20	41	6	3.1~3.4	
83.4	83.4	11		0.3		17	38	5	2.6~2.9	
73.0	73.0	11		0.3		15	37	4	2.1~2.4	
62.6	62.6	11		0.3		13	34	3	1.6~1.9	
52.1	52.1	11		0.2		11	31	2	1.1~1.4	
41.7	41.7	11		0.2		9	28	1	0.6~0.9	
31.3	31.3	12		0.2		7	25	0	0.1~0.4	

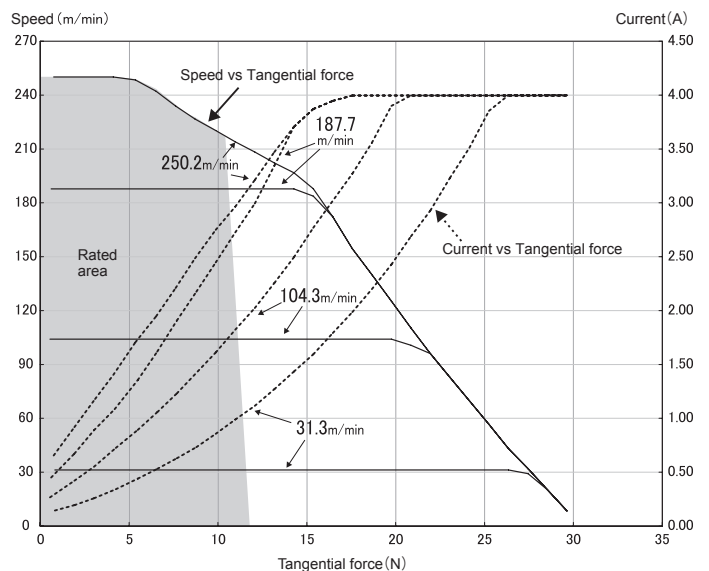

\*The values in the characteristics list are only for your reference and not the warranted values. The values represent the characteristics of a single standard motor roller (no linked operation) without including other specifications, and the values may change when including other specifications or with linked operation.

 [MDR Selection Tool] is available on our web page.

## Operating characteristics with HB-510N driver card

### PM570FE-17

Speed (m/min)		Tangential Force (N)		Input Current (A)		Power Input (W)	Power Output (W)	Rotary SW No	External input voltage (V)
No-load	Rated	Rated	Starting	No-load	Starting				
19.8	17.8	88	293	0.8	4.0	42	62	9	9.3~9.7
18.1	17.8	88		0.7		42	62	8	8.3~8.7
16.5	16.5	89		0.6		39	60	7	7.3~7.7
14.8	14.8	90		0.6		35	56	6	6.3~6.7
13.2	13.2	91		0.5		31	51	5	5.3~5.7
11.5	11.5	93		0.5		27	47	4	4.3~4.7
9.9	9.9	94		0.4		23	43	3	3.3~3.7
8.2	8.2	95		0.4		19	38	2	2.3~2.7
6.6	6.6	96		0.3		16	34	1	1.3~1.7
4.9	4.9	98		0.3		12	29	0	0.3~0.7

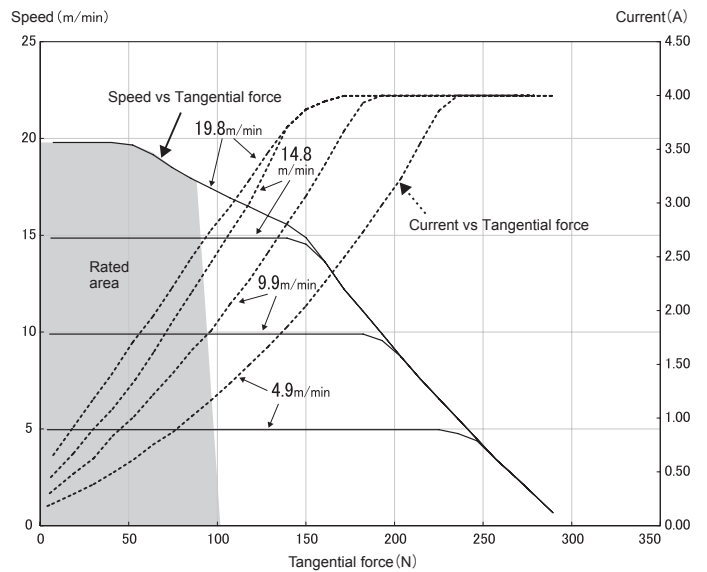

### PM570FE-60

Speed (m/min)		Tangential Force (N)		Input Current (A)		Power Input (W)	Power Output (W)	Rotary SW No	External input voltage (V)
No-load	Rated	Rated	Starting	No-load	Starting				
70.4	63.3	28	94	0.8	4.0	42	62	9	9.3~9.7
64.5	63.3	28		0.7		42	62	8	8.3~8.7
58.6	58.6	28		0.6		39	60	7	7.3~7.7
52.8	52.8	29		0.6		35	56	6	6.3~6.7
46.9	46.9	29		0.5		31	51	5	5.3~5.7
41.0	41.0	30		0.5		27	47	4	4.3~4.7
35.2	35.2	30		0.4		23	43	3	3.3~3.7
29.3	29.3	30		0.4		19	38	2	2.3~2.7
23.5	23.5	31		0.3		16	34	1	1.3~1.7
17.6	17.6	31		0.3		12	29	0	0.3~0.7

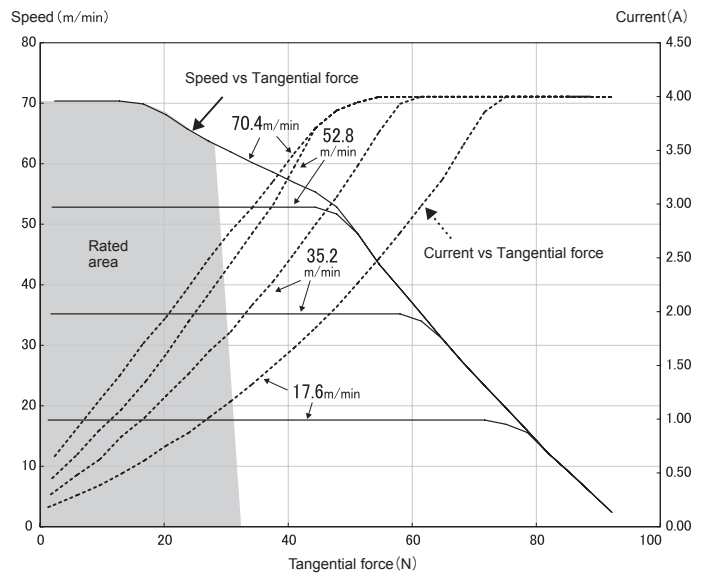

### PM570FE-210

Speed (m/min)		Tangential Force (N)		Input Current (A)		Power Input (W)	Power Output (W)	Rotary SW No	External input voltage (V)
No-load	Rated	Rated	Starting	No-load	Starting				
250.2	225.2	9	30	0.8	4.0	42	62	9	9.3~9.7
229.4	225.2	9		0.7		42	62	8	8.3~8.7
208.5	208.5	9		0.6		39	60	7	7.3~7.7
187.7	187.7	9		0.6		35	56	6	6.3~6.7
166.8	166.8	9		0.5		31	51	5	5.3~5.7
146.0	146.0	9		0.5		27	47	4	4.3~4.7
125.1	125.1	10		0.4		23	43	3	3.3~3.7
104.3	104.3	10		0.4		19	38	2	2.3~2.7
83.4	83.4	10		0.3		16	34	1	1.3~1.7
62.6	62.6	10		0.3		12	29	0	0.3~0.7

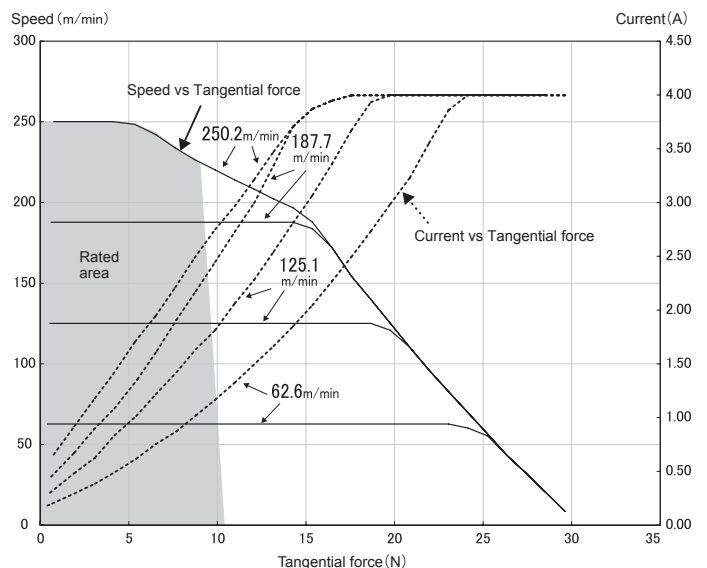

\*The values in the characteristics list are only for your reference and not the warranted values. The values represent the characteristics of a single standard motor roller (no linked operation) without including other specifications, and the values may change when including other specifications or with linked operation.